

# ELECTRICAL MOUNTING BLOCK INSTALLATION INSTRUCTIONS

INSTALL BASE PRIOR TO SIDING - MAXIMUM 7 LB. WEIGHT LIMIT ON FIXTURE

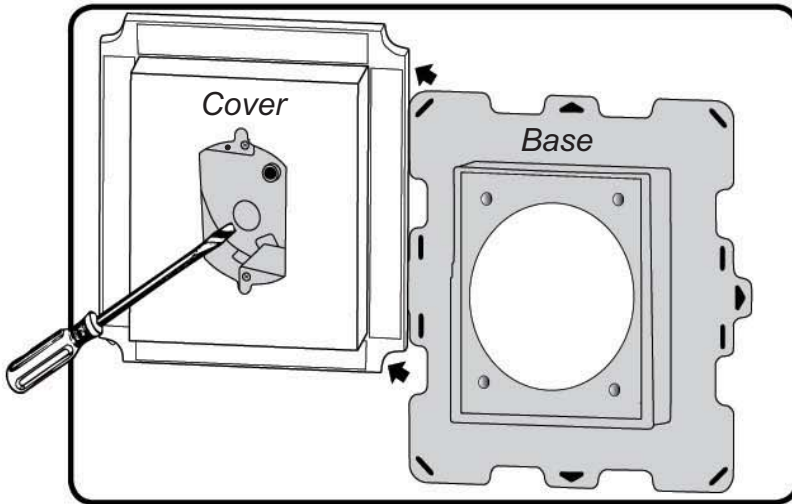

## STEP 1

Remove the Cover from the Base. Remove desired circular knockout area on gray outlet box using a screwdriver or utility knife. Set aside Cover to attach later.

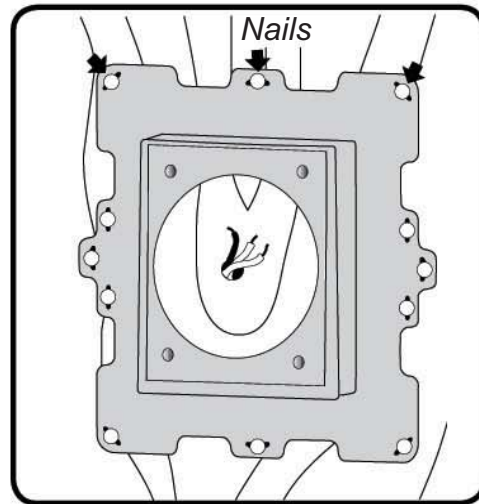

## STEP 2

Place the Base on the wall where wires are to be located. Fasten to wall as shown using roofing nails or screws in the provided slots. Use tape or sealant between block and the wall.

**NOTE:**  
Intended  
only for  
fixtures.

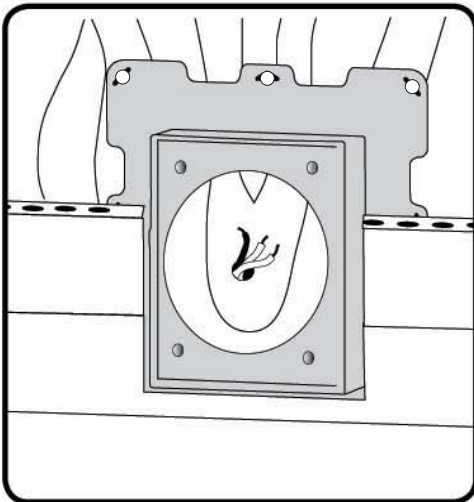

## STEP 3

Install siding around the Base according to the manufacturer's installation instructions.

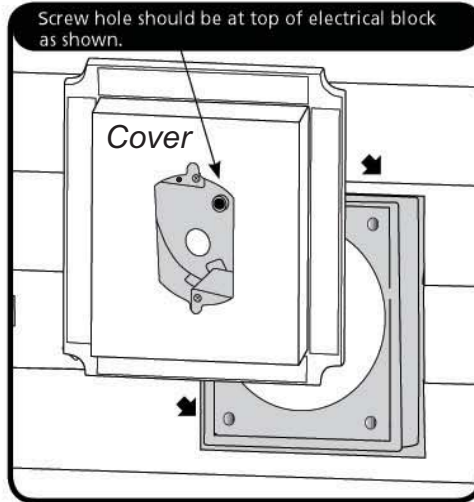

## STEP 4

After siding installation is complete, slide Cover back over the base in provided holes making sure to bring the wires through the knockout hole.

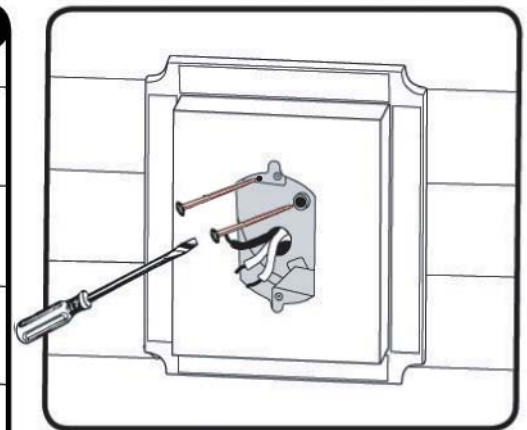

## STEP 5

Once the Cover is slid in place, screw the Cover to the Wall in the provided holes as shown taking care not to over tighten. Screw holes should be at top of electrical block as shown. Be sure screws are long enough to penetrate and extend through the sheathing no more than 1/8".

## STEP 6

Remove the 2 screws from the electrical box and use them to attach the light fixture to the box. Be sure that all electrical product gaskets have the proper sealants and the gap between fixture and block is completely sealed.

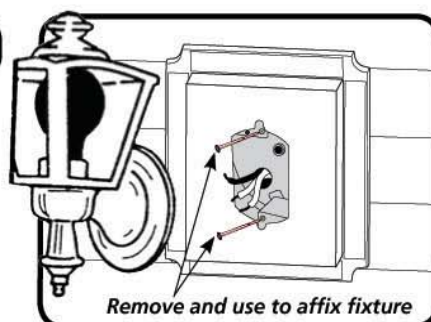

Toll Free: 1-800-407-4718